



Dulles Corridor Metrorail Project Status Update

Fairfax County
Transportation Advisory Commission

November 16, 2010

Richard Stevens
Fairfax County Department of Transportation

Dulles Corridor Metrorail Project

- Seamless integration with current 106-mile Metro system
- 23-mile extension that branches off existing Orange Line after East Falls Church Station, providing direct connections to DC without transfers
- 11 new stations
 - 5 in Phase 1
 - 6 in Phase 2
 - Phase 1: East Falls Church to Wiehle Avenue in Reston; opens in 2013
 - Phase 2: Wiehle Avenue through Dulles Airport to Ashburn; opening date not established



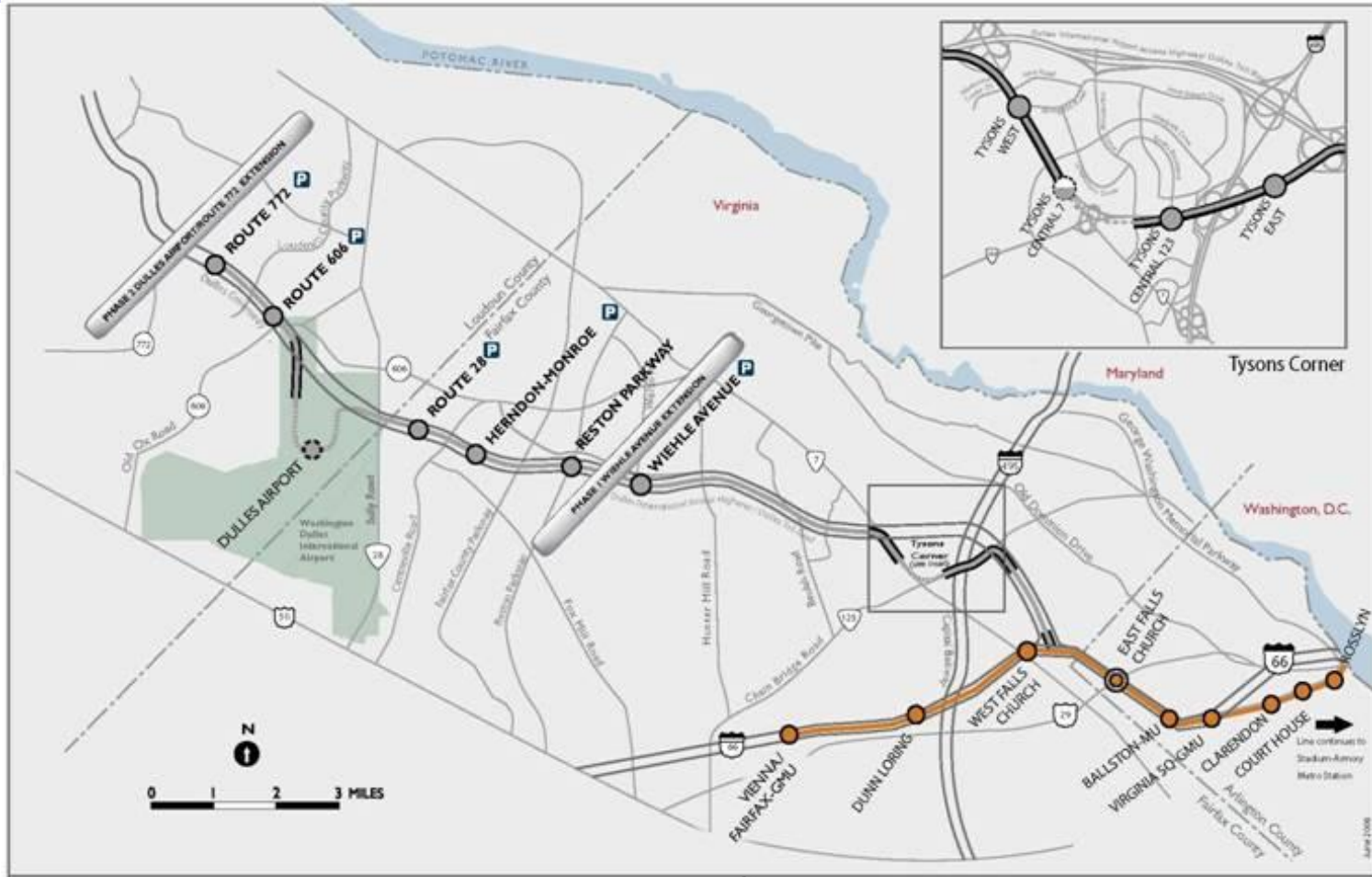



Dulles Corridor Metrorail Project

■ Phase 1 Schedule

<i>Final Design:</i>	<i>2008 – 2010</i>
<i>Utility Work:</i>	<i>2008 – 2010</i>
<i>Railcars Delivered:</i>	<i>2013 – 2014</i>
<i>Construction Period:</i>	<i>2009 – 2013</i>
<i>Passenger Service Begins:</i>	<i>December 2013</i>



Dulles Corridor Metrorail Project

- ***Phase 1 Construction Moving Forward***
- ***Construction of the Dulles Corridor Metrorail Project is under way along the 11.5 mile corridor, from East Falls Church to Reston.***
- ***Outbound Tunnel complete, Inbound Tunnel complete December 2010!***
- ***All 5 Phase 1 stations are now under construction!***

Construction 22 % COMPLETE!

Engineering 95% Complete!

I-66 AT THE DULLES CONNECTOR ROAD JUNCTION



STRADDLE BENT OVER I-66 WESTBOUND @ THE DCR



ERECTION TRUSS ALONG THE DCR





PLACEMENT OF CONCRETE SEGMENTS ALONG DCR @ RTE 123

ERECTION TRUSS @ I-495 AND RTE 123



TUNNEL CREW WARM-UP AT START OF SHIFT



TUNNEL BREAK-THROUGH



ROUTE 7 CONSTRUCTION



BRIDGE CONSTRUCTION OVER WO&D TRAIL AT DIAAH/DTR



WIEHLE AVENUE STATION





Dulles Corridor Metrorail Project – ***Reston East Relocation Plan***

■ **Phase I: November 28, 2010**

- Loss of up to 200 parking spaces
- Shift Routes 595 and 597 to Reston North Park and Ride (**Sunset Hills Rd and Wiehle Avenue**)
- Increase service on Route 585 to Reston South Park and Ride (**Reston Pkwy and Lawyers Rd**)
 - **Approx 200 parking spaces available for use**
- Routes 552 and 554 Will Operate to Reston North Park and Ride Lot
- Route 552 will service 50 parking spaces provided at Baron Cameron Park (**Wiehle Avenue entrance**)



Dulles Corridor Metrorail Project – ***Reston East Relocation Plan***

■ **Phase II: February 28, 2011**

- Full Closure of Reston East Park and Ride
- Open new Sunset Hills Interim Park and Ride Lot
(Sunset Hill Rd and Town Center Pkwy)
- New bus service to West Falls Church
 - Route 555 @ 10 minute frequency
- Enhanced Route 505 service
 - Serving Town Center and Sunset Hills Interim P&R Lot

Dulles Corridor Metrorail Project

- Phase 2:
 - 11.6 mile extension from Wiehle Avenue in Reston to Ashburn
- 6 stations:
 - Three in Fairfax County
 - Three in Loudoun county, including Dulles International Airport
- Rail Yard & Maintenance Facility
 - 180 railcar capacity
- 5 Parking Garages

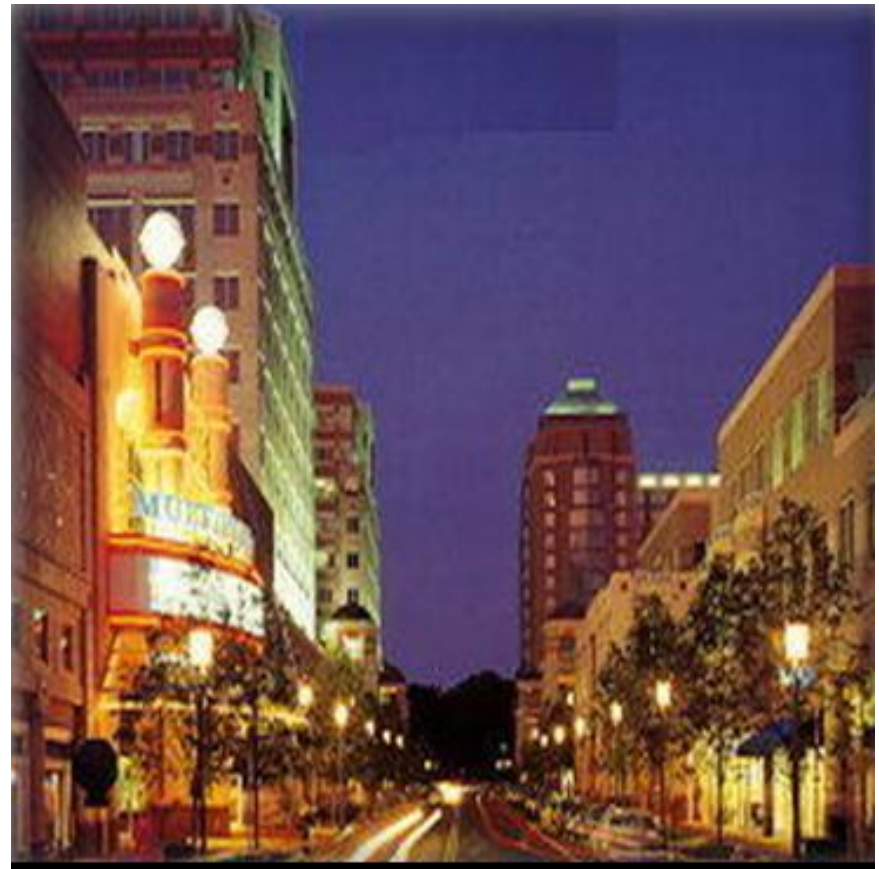



Dulles Corridor Metrorail Project

- **Phase 2 Schedule**

- **Preliminary Engineering** **12/09 – 03/11**
 - **Alternative Alignments evaluated at Dulles International Airport**
- **Design Build Notice To Proceed** **Late 2011**
- **Design Build Significant Completion** **12/16**



Dulles Corridor Metrorail Project

■ **DIA Alignment Study**

Study Rationale

- Concerns About Costs and Risks of Tunnel and Underground Station
 - No Federal or State Funding Anticipated for Phase 2
 - Reliance on DTR Revenues for Majority of Funding
- Airports Authority Board Requested Study of More Cost-Effective Solutions for Serving Airport
- Study Purpose is to Identify and Evaluate Extensive Range of Airport Alignment and Station Location Alternatives
- Assessment of Effects to Historic Properties and Additional 106 Consultation Key Part of Study Process



Dulles Corridor Metrorail Project

Alternative 8A – Aerial on South Face of North Garage

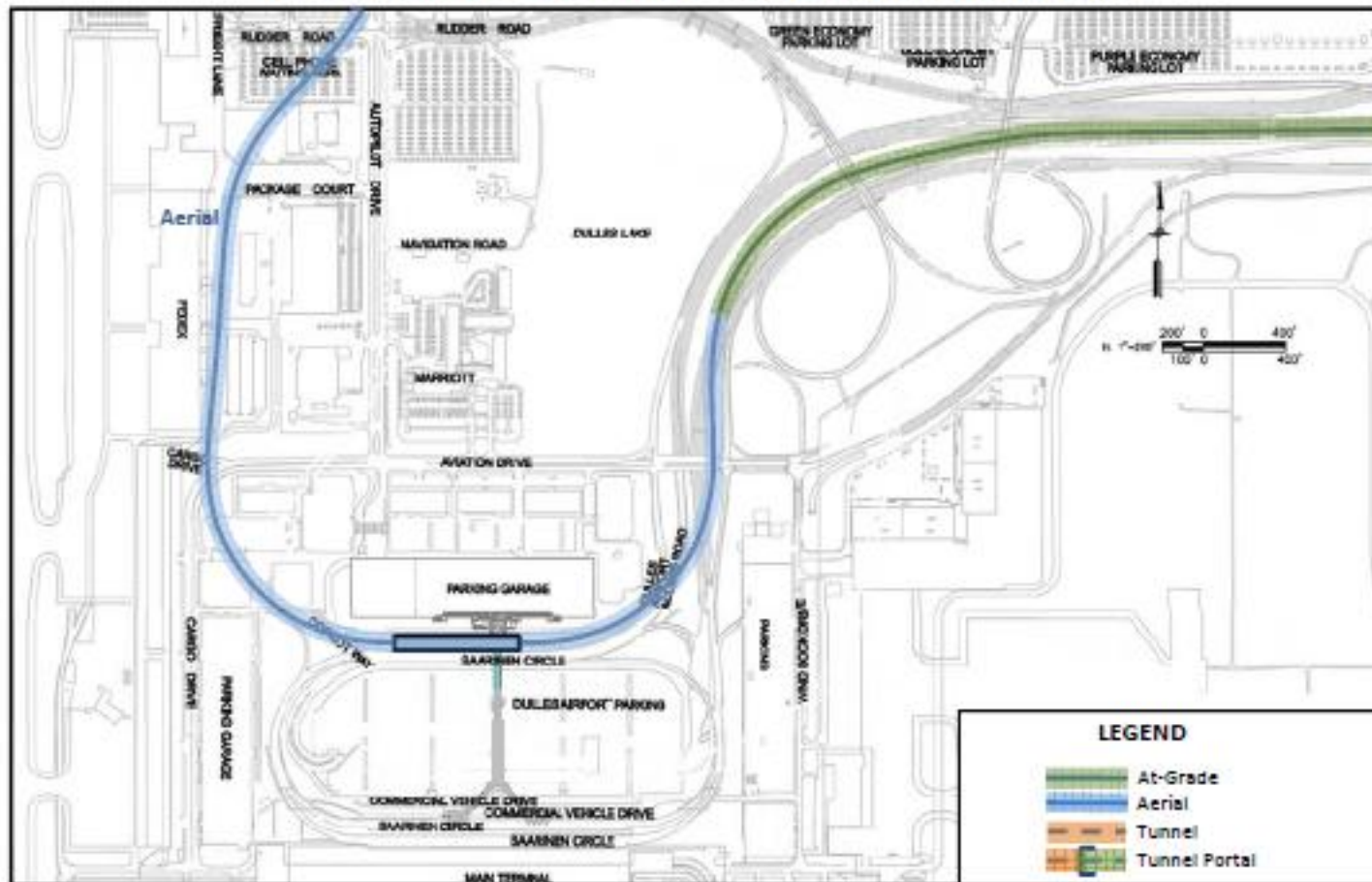

Dulles Corridor Metrorail Project

Comparison of Underground Alignment to North Garage Alignment

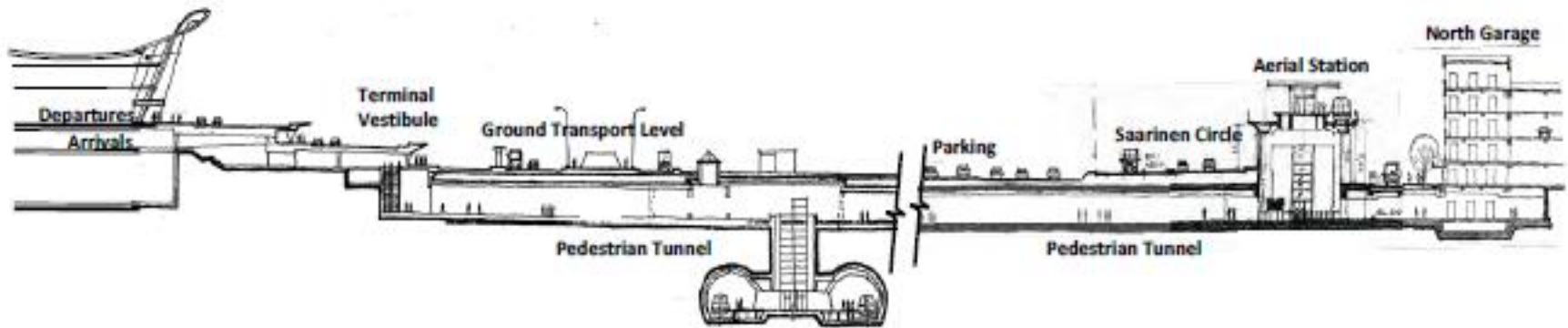

Dulles Corridor Metrorail Project

- **North Garage Alignment**



Dulles Corridor Metrorail Project

- Effects on View Shed of Aerial Alignment
 - From the Main Terminal



Existing View



Illustrative View with Design Option

Dulles Corridor Metrorail Project

- Effects on the View Shed
 - From Saarinen Circle



Existing View



Illustrative View with Design Option